

FirstView[®] Self-Guided Tools

**Registering with
your School Code**



FirstView®
Self-Guided Tools



Step 1:
Download app, Register,
& Log-in.



FirstView® Self-Guided Tools

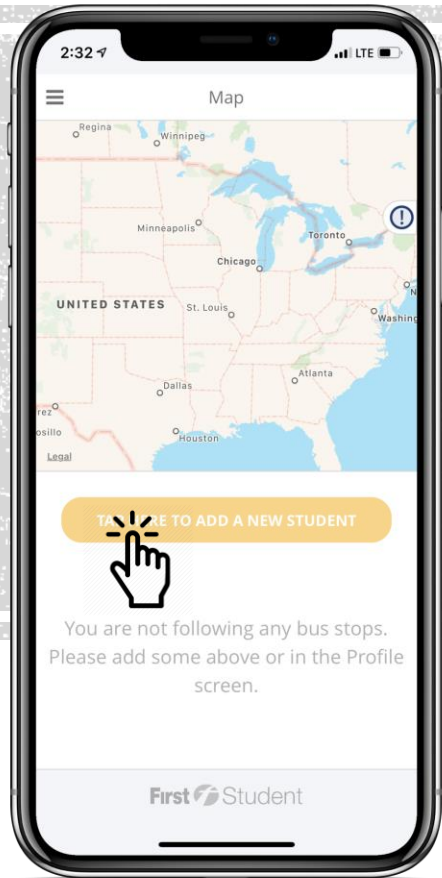

Step 2:
Click the yellow message
box to add you first
student.



FirstView® Self-Guided Tools

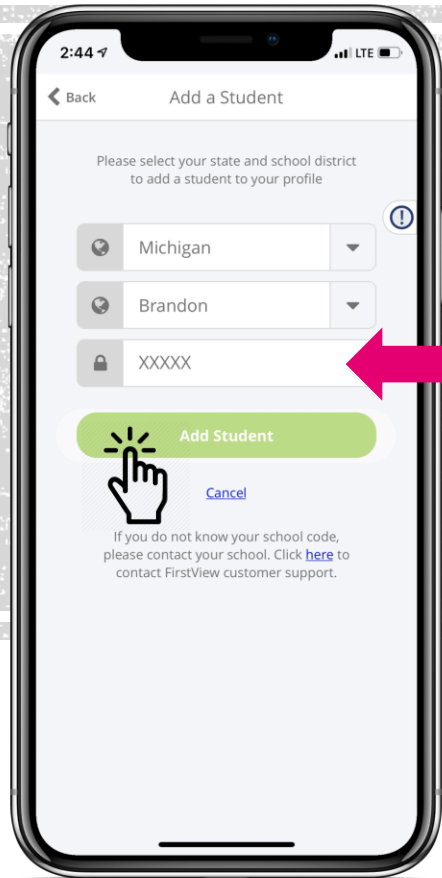

Step 3:
Select your state and school district from the drop-down. Add your school code.* Click 'Add Student'.



* If you do not know your school code, please contact your school district.

FirstView® Self-Guided Tools

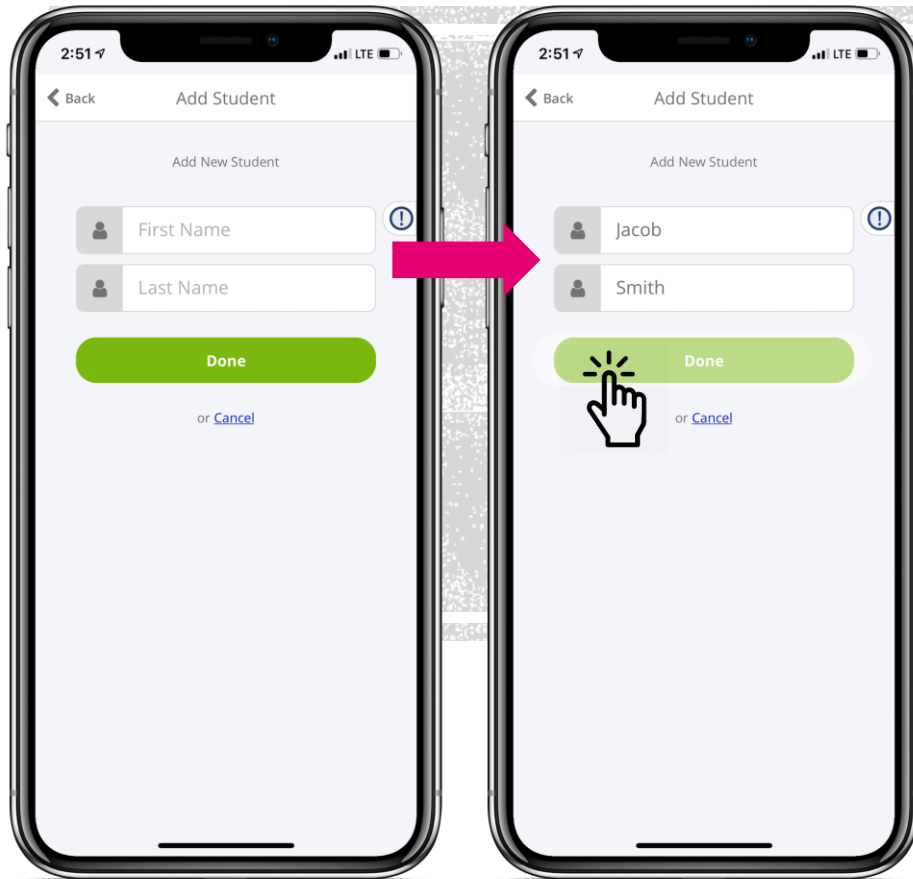

Step 4:
Enter your student's first
and last name.
Click 'Done'.





Your student is added!

Next, let's add your student's assigned stop.



FirstView® Self-Guided Tools

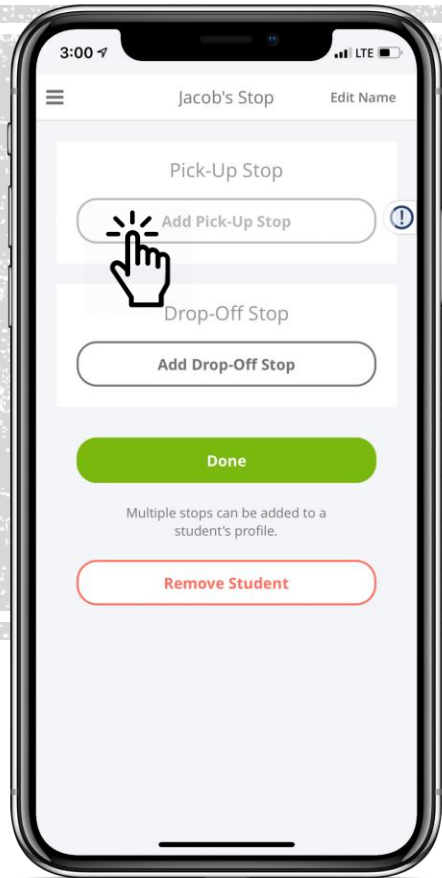

Step 1:
Click 'Add Pick-Up' Stop.



FirstView® Self-Guided Tools

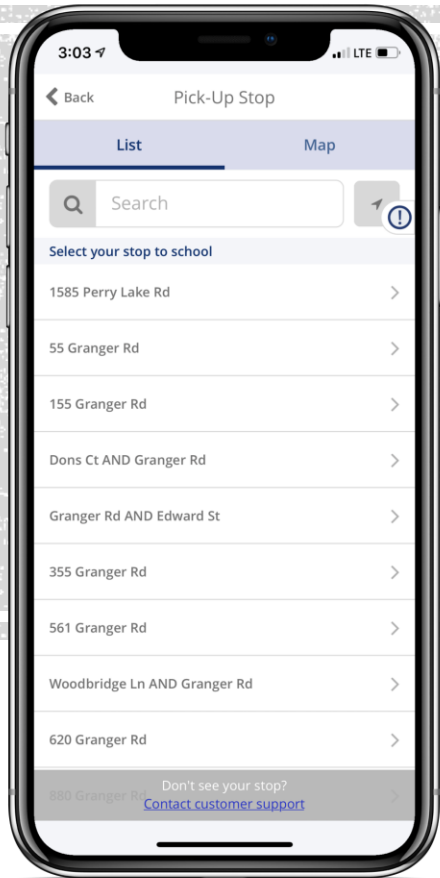

Step 2:
Click 'List'.
Type in your stop address.
Click on the correct stop
from the search results.



FirstView® Self-Guided Tools

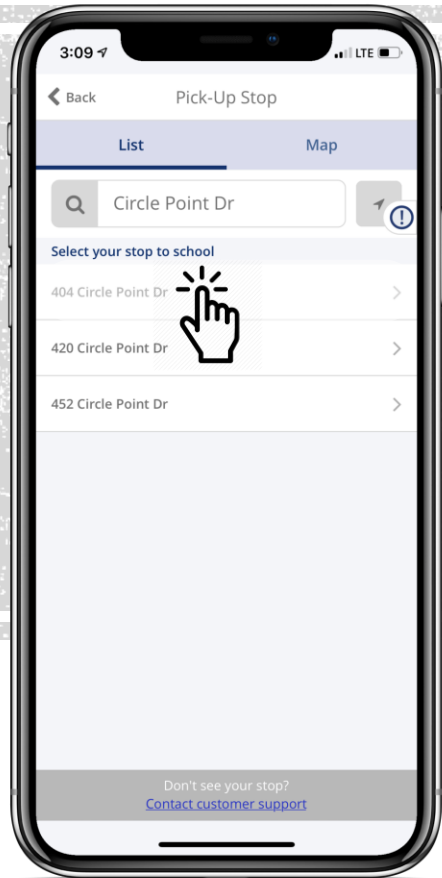

Step 3:

All available stops matching your search will appear.*
Select the stop address you'd like to add.



* Don't see your stop available? Reach out to our support team at support@firstviewapp.com for help.

FirstView® Self-Guided Tools

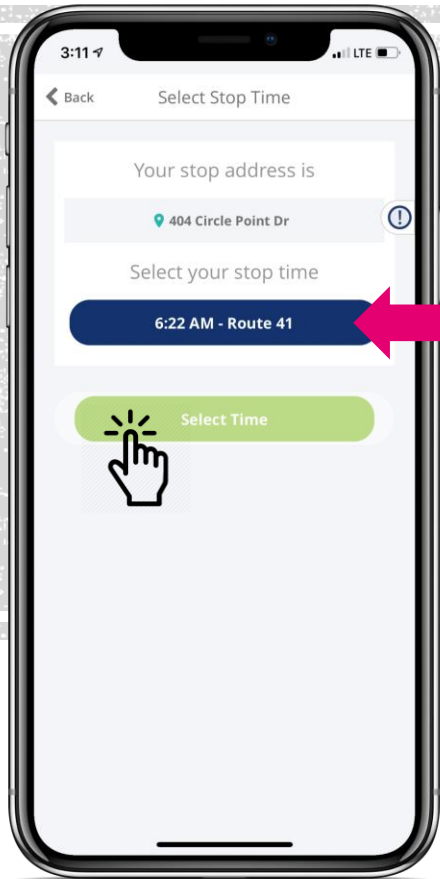

Step 4:
Select from the available times listed for your stop. Click 'Select Time' to confirm.



FirstView® Self-Guided Tools

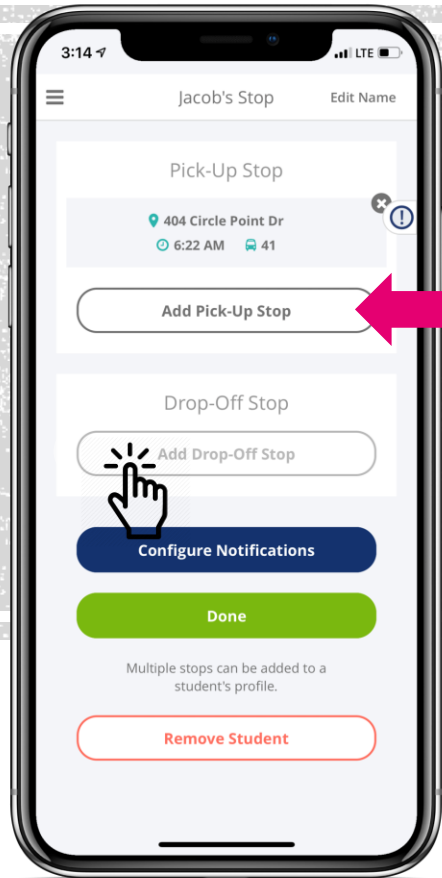

Step 5:

The pick-up stop is added.
Click 'Add Drop-Off Stop' to
add the afternoon stop.



FirstView® Self-Guided Tools



Step 6:
Click 'Map'
Click on a circle to zoom in
and view that group of stops.



FirstView® Self-Guided Tools

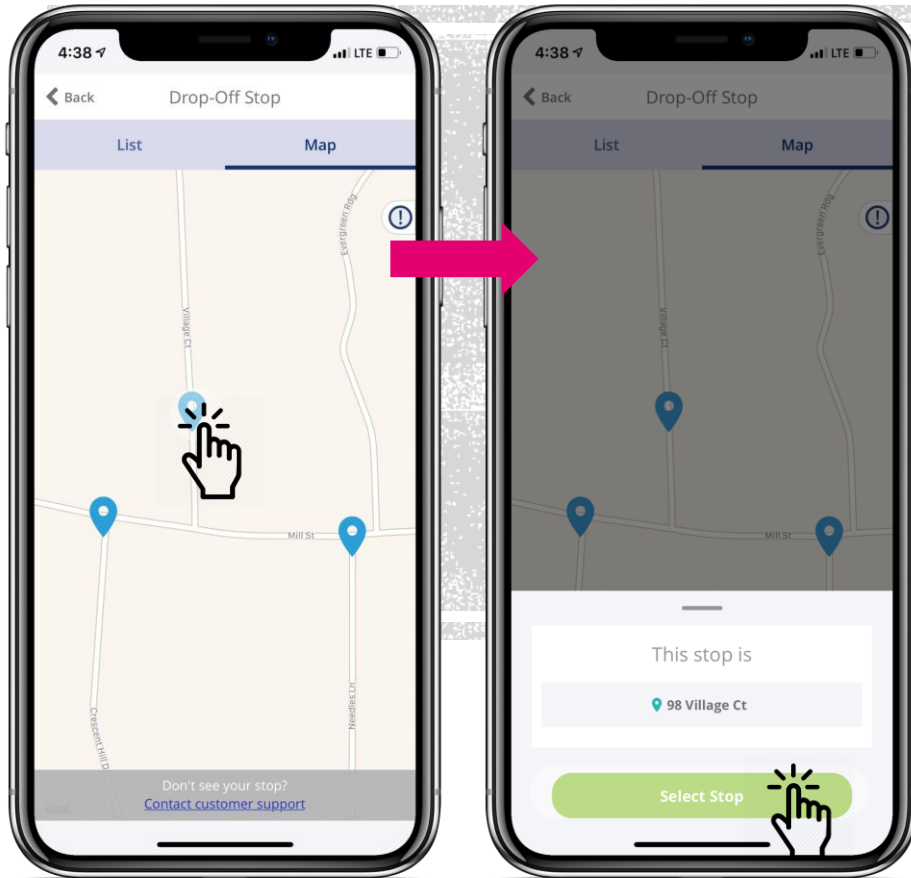

Step 7:
Click the stop icon to
view the stop address.
Click 'Select Stop' to
confirm.



FirstView® Self-Guided Tools

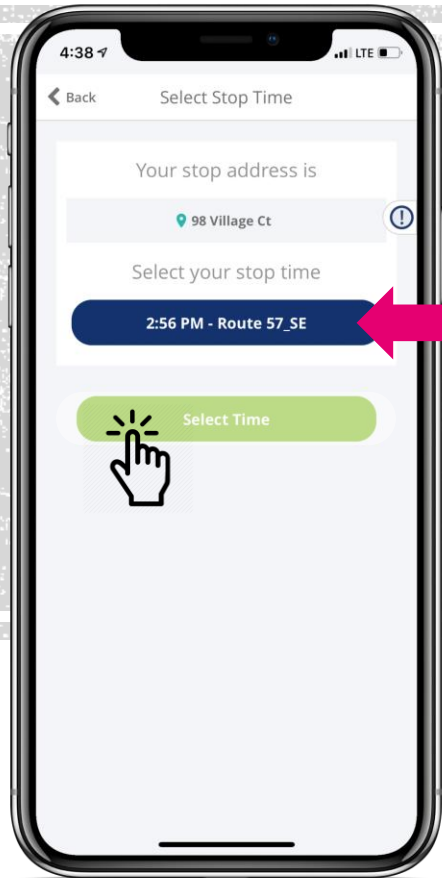

Step 8:
Select from the available times listed for your stop. Click 'Select Time' to confirm.



* Don't see your stop available? Reach out to our support team at support@firstviewapp.com for help.

FirstView® Self-Guided Tools

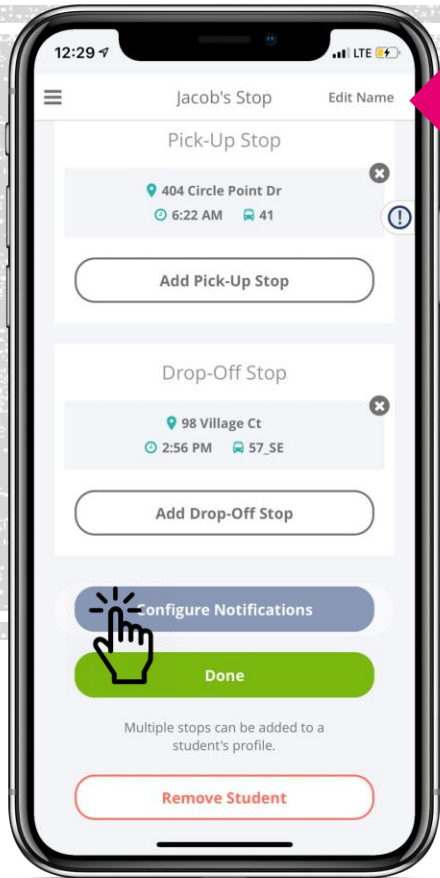

Step 9:
The drop-off stop is added. Click 'Configure Notifications' to set up alerts.



FirstView® Self-Guided Tools

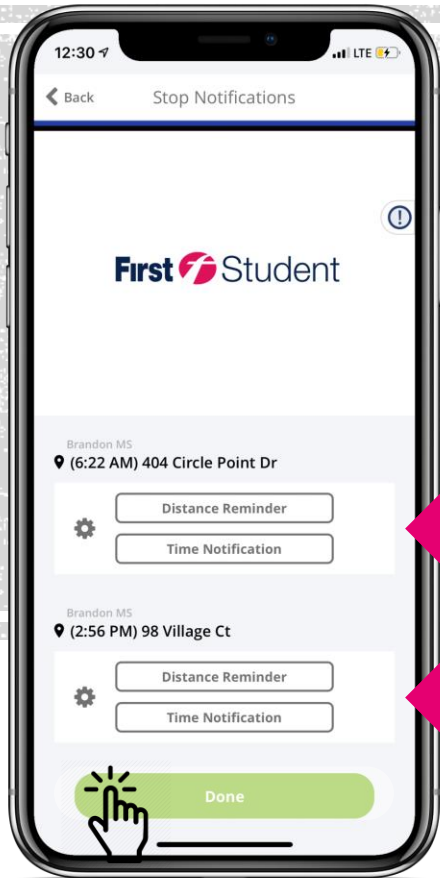

Step 10:
Setup optional alerts for
your student's routes.
These can be edited from
your profile later on as well.



FirstView® Self-Guided Tools

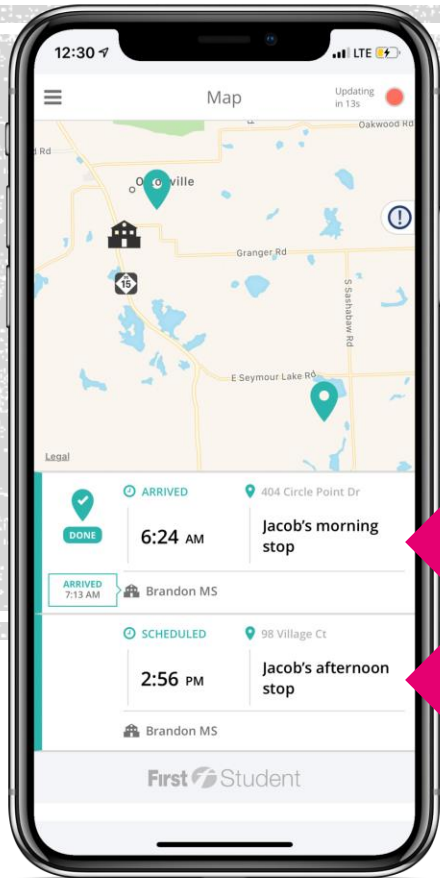

Step 11:
Your student's stop
information is now
displayed on the map for
tracking.



**Thank You for
being a FirstView
Customer!**

