

# FirstView<sup>®</sup> Self-Guided Tools

**Registering with  
your School Code**



FirstView®  
Self-Guided Tools



**Step 1:**  
Download app, Register,  
& Log-in.



# FirstView® Self-Guided Tools

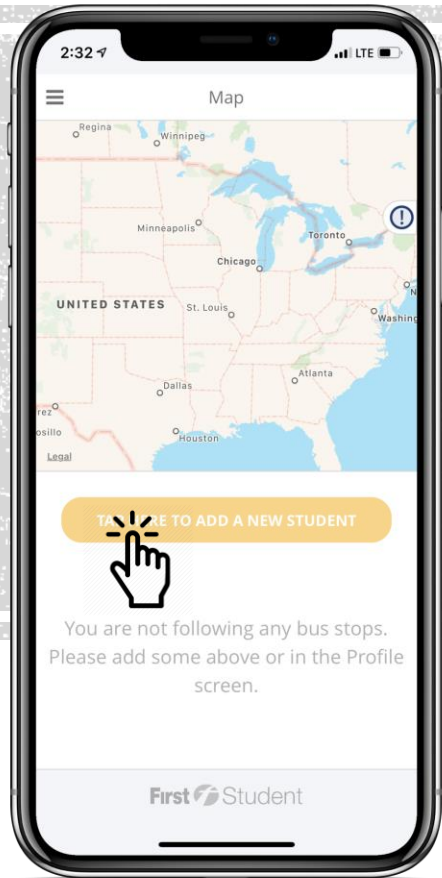

**Step 2:**  
Click the yellow message  
box to add you first  
student.



# FirstView® Self-Guided Tools

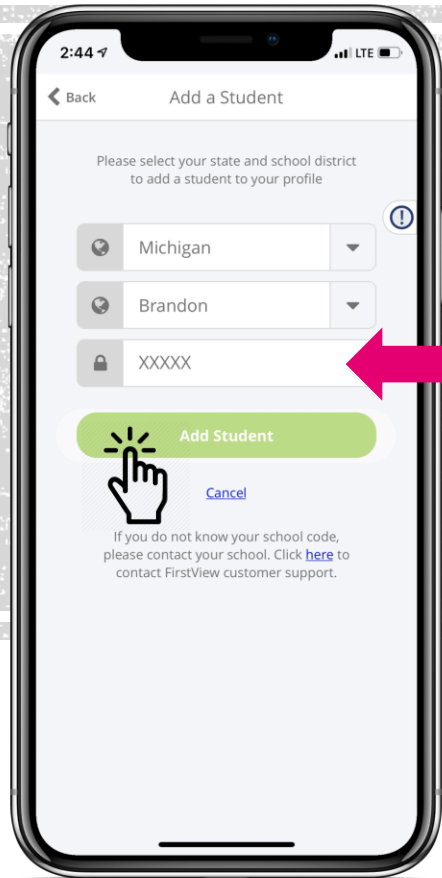

**Step 3:**  
Select your state and school district from the drop-down. Add your school code.\* Click 'Add Student'.



\* If you do not know your school code, please contact your school district.

# FirstView® Self-Guided Tools

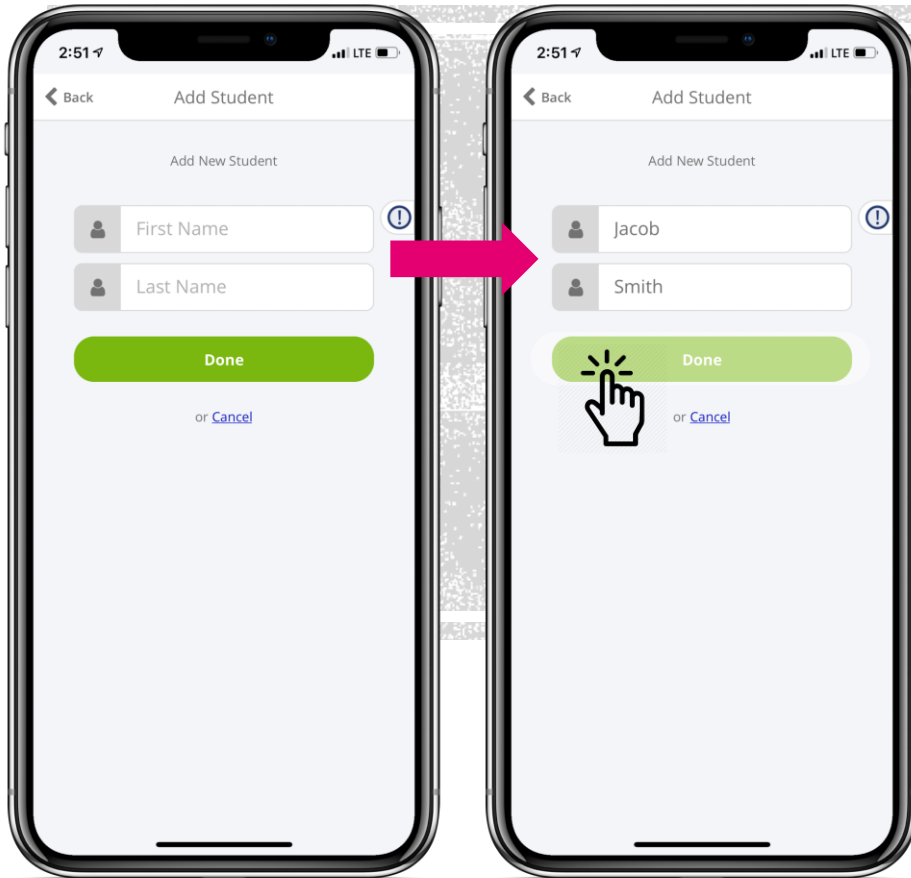

**Step 4:**  
Enter your student's first  
and last name.  
Click 'Done'.





# Your student is added!

Next, let's add your student's assigned stop.



# FirstView® Self-Guided Tools

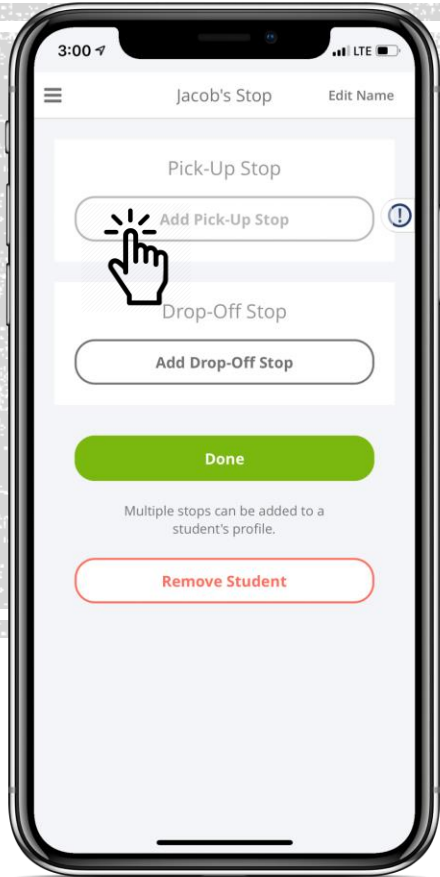

**Step 1:**  
Click 'Add Pick-Up' Stop.



# FirstView® Self-Guided Tools

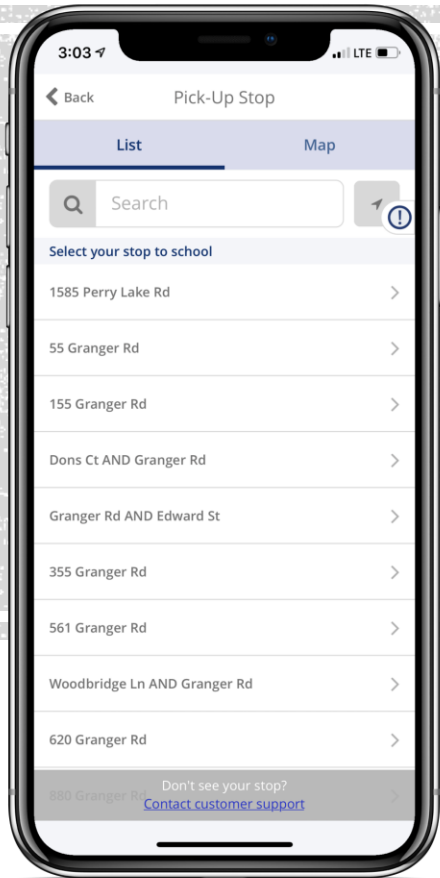

**Step 2:**  
Click 'List'.  
Type in your stop address.  
Click on the correct stop  
from the search results.





# FirstView® Self-Guided Tools

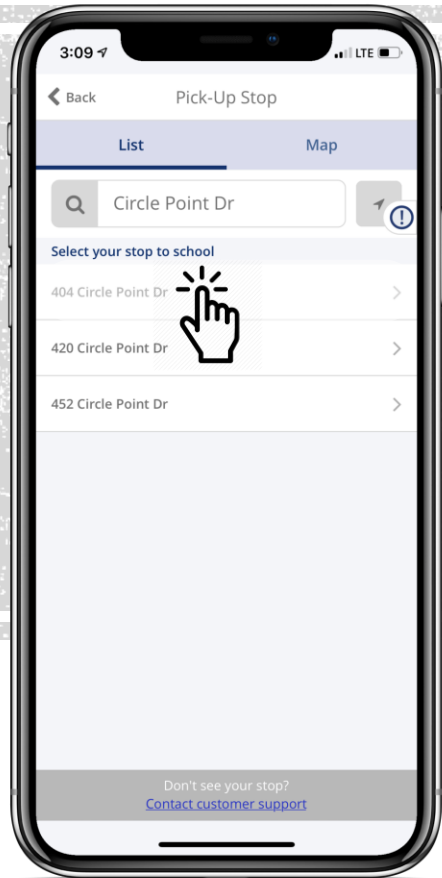

## Step 3:

All available stops matching your search will appear.\*  
Select the stop address you'd like to add.



\* Don't see your stop available? Reach out to our support team at [support@firstviewapp.com](mailto:support@firstviewapp.com) for help.

# FirstView® Self-Guided Tools

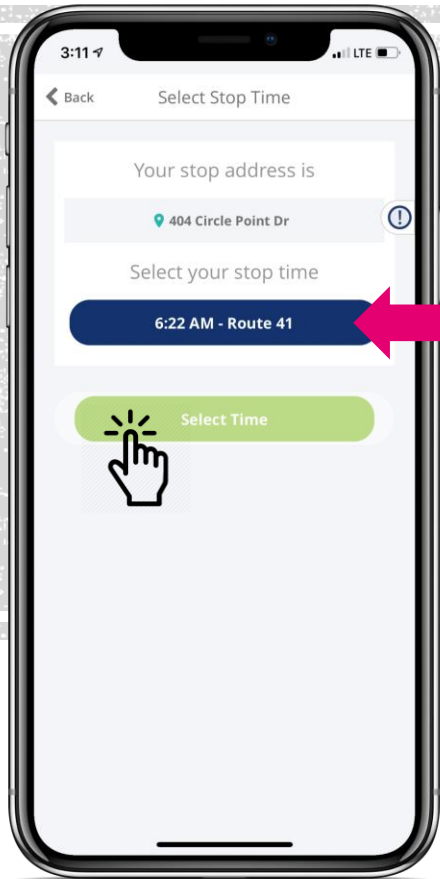

**Step 4:**  
Select from the available times listed for your stop. Click 'Select Time' to confirm.



# FirstView® Self-Guided Tools

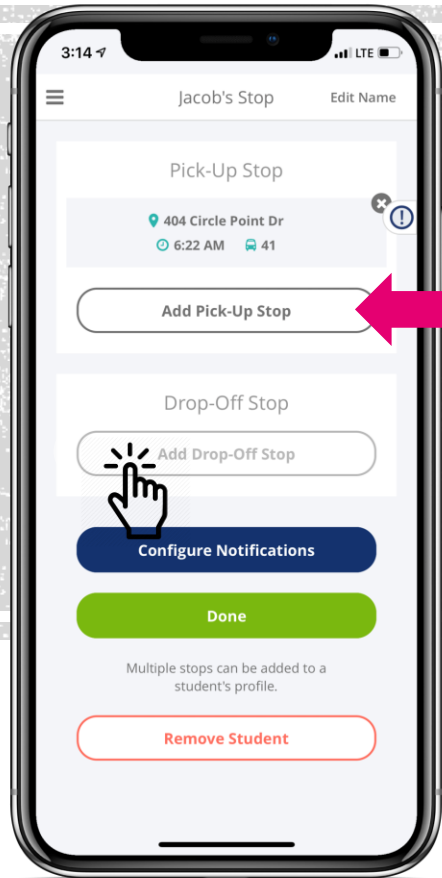

## Step 5:

The pick-up stop is added.  
Click 'Add Drop-Off Stop' to  
add the afternoon stop.



# FirstView® Self-Guided Tools



**Step 6:**  
Click 'Map'  
Click on a circle to zoom in  
and view that group of stops.



# FirstView® Self-Guided Tools

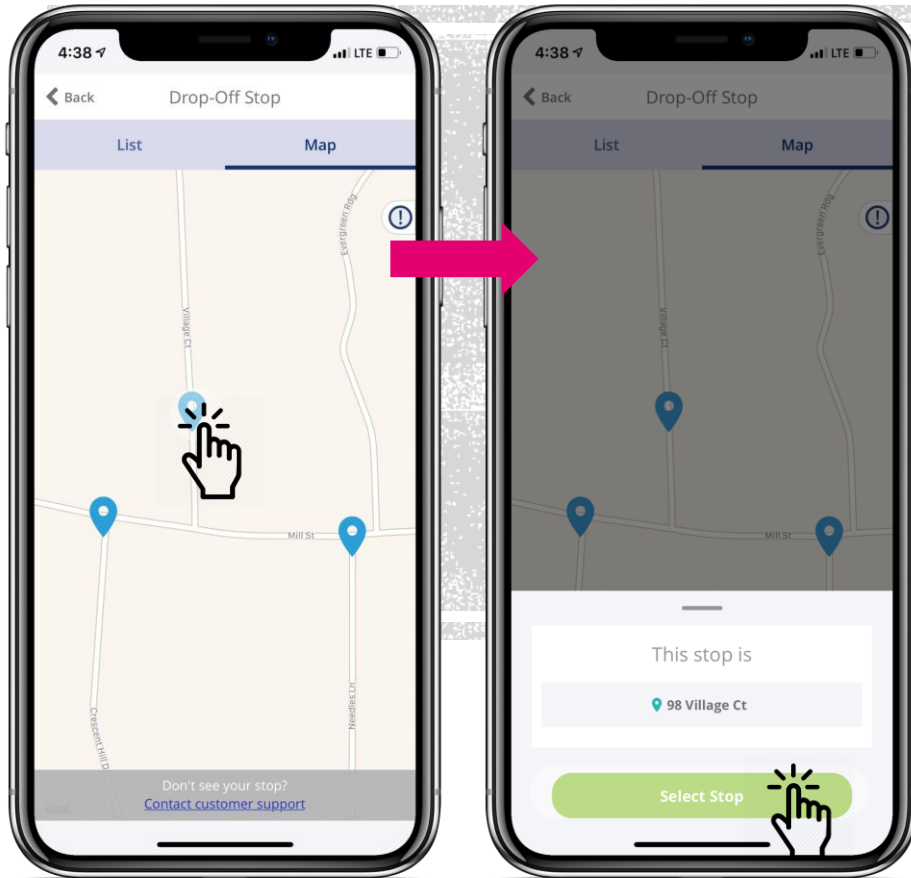

**Step 7:**  
Click the stop icon to  
view the stop address.  
Click 'Select Stop' to  
confirm.



# FirstView® Self-Guided Tools

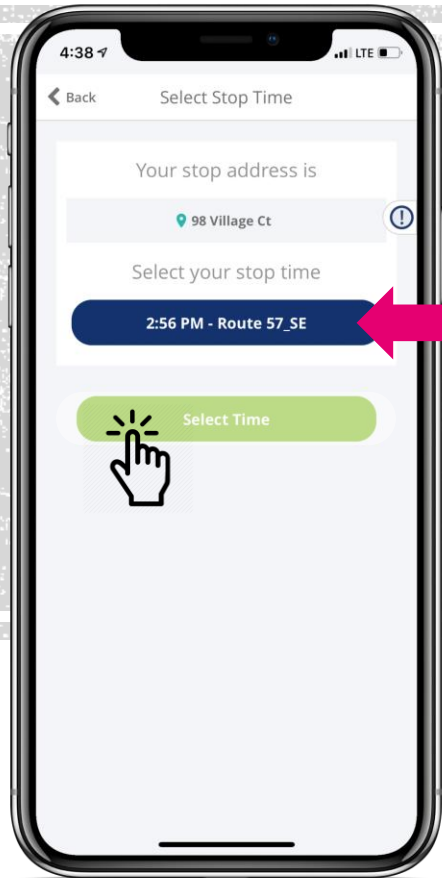

**Step 8:**  
Select from the available times listed for your stop. Click 'Select Time' to confirm.



\* Don't see your stop available? Reach out to our support team at [support@firstviewapp.com](mailto:support@firstviewapp.com) for help.

# FirstView® Self-Guided Tools

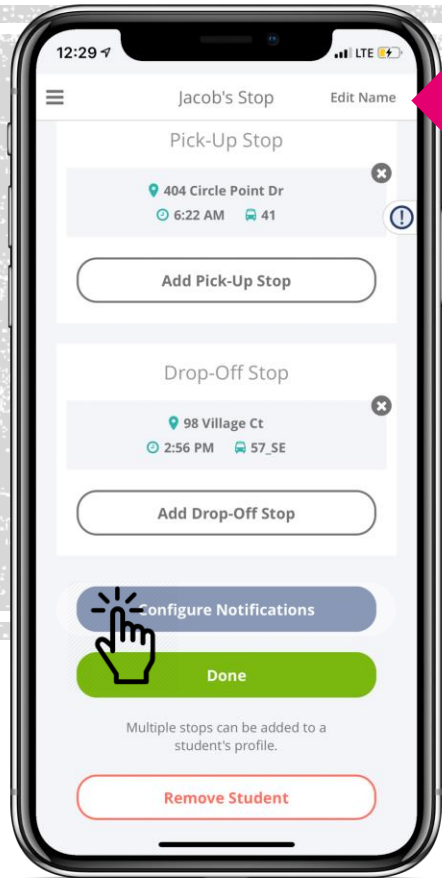

**Step 9:**  
The drop-off stop is added. Click 'Configure Notifications' to set up alerts.



# FirstView® Self-Guided Tools

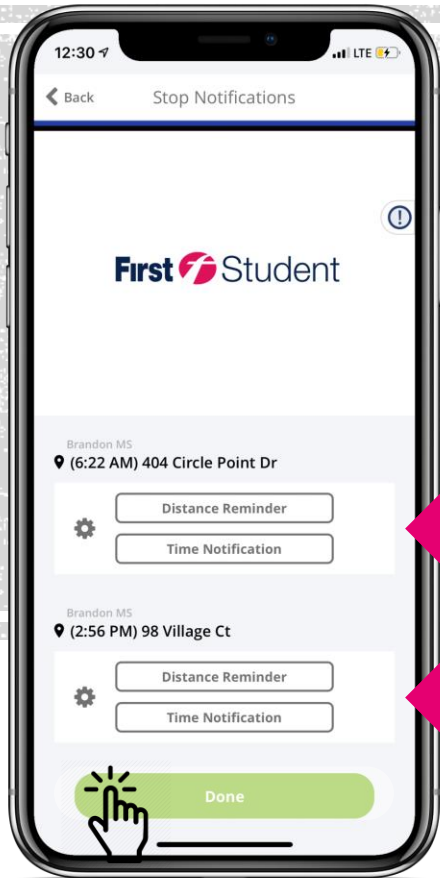

**Step 10:**  
Setup optional alerts for  
your student's routes.  
These can be edited from  
your profile later on as well.





# FirstView® Self-Guided Tools

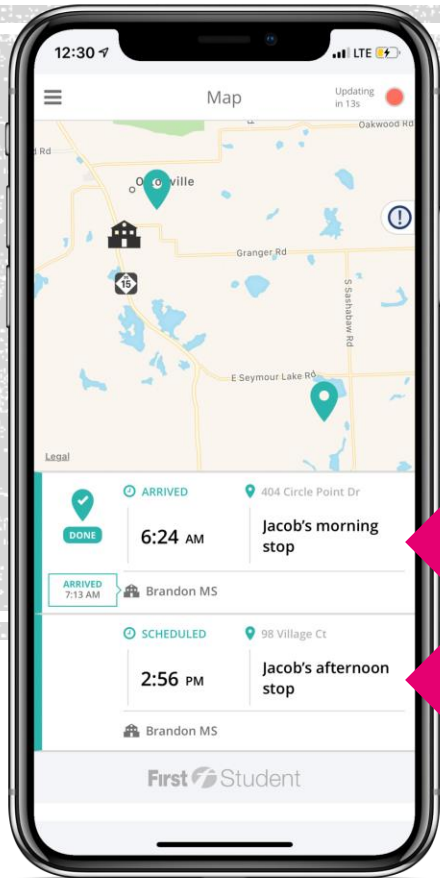

**Step 11:**  
Your student's stop information is now displayed on the map for tracking.



**Thank You for  
being a FirstView  
Customer!**

